

PROJECT SUMMARY				
THIS PROJECT CONSISTS OF A REMODEL TO AN EXISTING CHICK-FIL-A RESTAURANT AND ### SF REAR ADDITION, ## SF DRIVE-THRU EXPANSION, NEW CANOPIES, NEW REFUSE ENCLOSURE AND STORAGE.				
APPLICABLE CODES & STANDARDS				
BUILDING:	FLORIDA BUILDING CODE, BUILDING, 7TH EDITION (2020)			
FIRE / LIFE SAFETY:	FLORIDA FIRE PREVENTION CODE, 7TH EDITION (2020) NFPA 101 - LIFE SAFETY CODE - 2018 EDITION NFPA 72, NATIONAL FIRE ALARM AND SIGNALING CODE - 2016 EDITION NFPA 96 - STANDARD FOR COMMERCIAL COOKING OPERATIONS - 2017 EDITION CHAPTER 120-3-3 RULES AND REGULATIONS FOR THE STATE MIN. FIRE SAFETY STANDARDS.			
EXISTING BUILDING:	FLORIDA BUILDING CODE, EXISTING BUILDING, 7TH EDITION (2020)			
PLUMBING:	FLORIDA BUILDING CODE, PLUMBING, 7TH EDITION (2020)			
FUEL:	FLORIDA BUILDING CODE, FUEL GAS, 7TH EDITION (2020)			
MECHANICAL:	FLORIDA BUILDING CODE, MECHANICAL, 7TH EDITION (2020)			
ELECTRICAL:	NATIONAL ELECTRICAL CODE - (NFPA 70) 2017 EDITION			
ENERGY:	ENERGY CONSERVATION, 7TH EDITION (2020)			
ACCESSIBILITY:	FLORIDA BUILDING CODE, ACCESSIBILITY, 7TH EDITION (2020)			
* PLUS DCA AMENDMENTS TO THE INTERNATIONAL CODES				
AUTHORITIES HAVING JURISDICTION				
BUILDING:	City of Pompano Beach, Building Department			
FIRE / LIFE SAFETY:	Pompano Beach Fire Rescue			
OCCUPANCY CLASSIFICATION				
(LSC Chapter 6 Classification of Occupancy and Hazardous Contents) (F.B.C. Chapter 3 - Use and Occupancy Classification)				
ASSEMBLY OCCUPANCY (LSC) ASSEMBLY GROUP A-2 (IBC)				
CONSTRUCTION TYPE				
(FBC Chapter 6 - Types of Construction)				
BUILDING:	TYPE VB CONSTRUCTION, NON-SPRINKLERED			
FIRE RESISTANCE OF BLDG. ELEMENTS BY CONSTRUCTION TYPE				
PRIMARY STRUCT. FRAME:	0 HOURS			
BEARING WALLS - EXT:	0 HOURS			
BEARING WALLS - INT:	0 HOURS			
NONBEARING WALLS - EXT:	SEE TABLE 602			
NONBEARING WALLS - INT:	0 HOURS			
FLOOR CONSTRUCTION:	0 HOURS			
ROOF CONSTRUCTION:	0 HOUR			
CORRIDORS:	NO RATING PER LSC SECTION 12.3.6 EXCEPTION (1)			
EXIT STAIRS:	NOT APPLICABLE: NO STAIRS ARE PROVIDED FOR THIS PROJECT.			
FLOOR OPENINGS / SHAFTS:				
NOT APPLICABLE: NO FLOOR OPENINGS OR SHAFTS ARE BEING PROVIDED FOR THIS PROJECT.				
BUILDING HEIGHT BY CONSTRUCTION TYPE				
(F.B.C. Chapter 5 - General Building Heights and Areas)				
ALLOWABLE HEIGHT:	1 STORY / 400 FT.			
ACTUAL BUILDING HEIGHT:	1 STORY / 23' - 2"			
BUILDING AREA BY CONSTRUCTION TYPE				
(F.B.C. Chapter 5 - General Building Heights and Areas)				
ALLOWABLE BUILDING AREA:	6,000 SF			
ACTUAL BUILDING AREA:	4,251 SF			
NO HEIGHT OR AREA INCREASES ARE UTILIZED. THE BUILDING AREA, HEIGHT AND NUMBER OF STORIES ARE WITHIN THE LIMITATIONS OF THE IBC CHAPTER 5				
OPENING PROTECTIVES IN FIRE RESISTANT CONSTRUCTION				
NOT APPLICABLE - NO FIRE RESISTANT CONSTRUCTION IS BEING PROVIDED IN THIS PROJECT.				
INTERIOR FINISHES				
CONSTRUCTION TYPE	FIRE RESISTANCE RATING			
EXITS	CLASS A			
EXIT ACCESS CORRIDORS	CLASS B			
OTHER THAN EXITS	CLASS C			
LOW HEIGHT PARTITIONS	CLASS C (SEE NOTE 1)			
INTERIOR FLOOR FINISHES	CLASS II			
GENERAL ASSEMBLY AREAS (>300)	CLASS B			
ASSEMBLY AREAS (<300)	CLASS C			
NOTES: 1. PARTITIONS NOT EXCEEDING 60 INCHES AND IN LOCATIONS OTHER THAN EXITS				
OCCUPANT LOADS				
THE CALCULATED OCCUPANT LOAD RESULTS IN A TOTAL BUILDING POPULATION FOR EGRESS OF <b>104 PERSONS</b> AS INDICATED BELOW. REFER TO EGRESS CAPACITY TABLES BELOW FOR EGRESS BY FLOOR OR AREA. REFER TO THE LIFE SAFETY DRAWINGS FOR THE OCCUPANCY SCHEDULES.				
OCCUPANT LOAD	PROVIDED EGRESS			
TOTAL CAPACITY FOR EGRESS	104 PERSONS 1,140 PERSONS			
EGRESS CAPACITY				
REFER TO THE LIFE SAFETY DRAWINGS FOR THE LOCATION AND CAPACITY OF ALL EGRESS COMPONENTS				
EXITS				
EXIT WIDTH - REQUIRED	EXIT WIDTH - PROVIDED			
104 PERSONS X 0.2' = 20.8 INCHES	180 INCHES			
MINIMUM AISLE WIDTH				
REFER TO THE SECTION 1029 FBC - SPECIFICALLY 1029.9.1				
MINIMUM AISLE WIDTH				
LESS THAN 50 OCCUPANTS = 36" CLEAR ON ONE SIDE OR BOTH				
LESS THAN 50 OCCUPANTS AND NOT PART OF AN ACCESSIBLE ROUTE = 30" CLEAR				
LESS THAN 15 OCCUPANTS = NOT PART OF ACCESSIBLE ROUTE				
OCCUPANT LOAD SCHEDULE				
Name	Area	Occupancy	AREA PER OCCUPANT	TOTAL OCCUPANTS
ORDER	115 SF	ASSEMBLY-STANDING	7 SF	17
DINING	982 SF	ASSEMBLY-UNCONCENTRATED	15 SF	66
ENTRY A	54 SF	BUSINESS	150 SF	1
MENS RR	91 SF	BUSINESS	150 SF	1
OFFICE	50 SF	BUSINESS	150 SF	1
PLAY AREA TO REMAIN	292 SF	BUSINESS	150 SF	2
RESTROOM VEST.	59 SF	BUSINESS	150 SF	1
WOMENS RR	107 SF	BUSINESS	150 SF	1
DRIVE-THRU	308 SF	KITCHEN	200 SF	2
KITCHEN	1097 SF	KITCHEN	200 SF	6
SERVING	262 SF	KITCHEN	200 SF	2
MECHANICAL	92 SF	STORAGE	300 SF	1
SERVICE	93 SF	STORAGE	300 SF	1
WALK-IN COOLER	96 SF	STORAGE	300 SF	1
WALK-IN FREEZER	116 SF	STORAGE	300 SF	1
TOTAL OCCUPANTS				104
SEAT QUANTITY (SEE FURNITURE PLANS): <b>66 PERSONS</b> CALCULATED TOTAL OCCUPANT LOAD: <b>104 PERSONS</b>				
2		1		

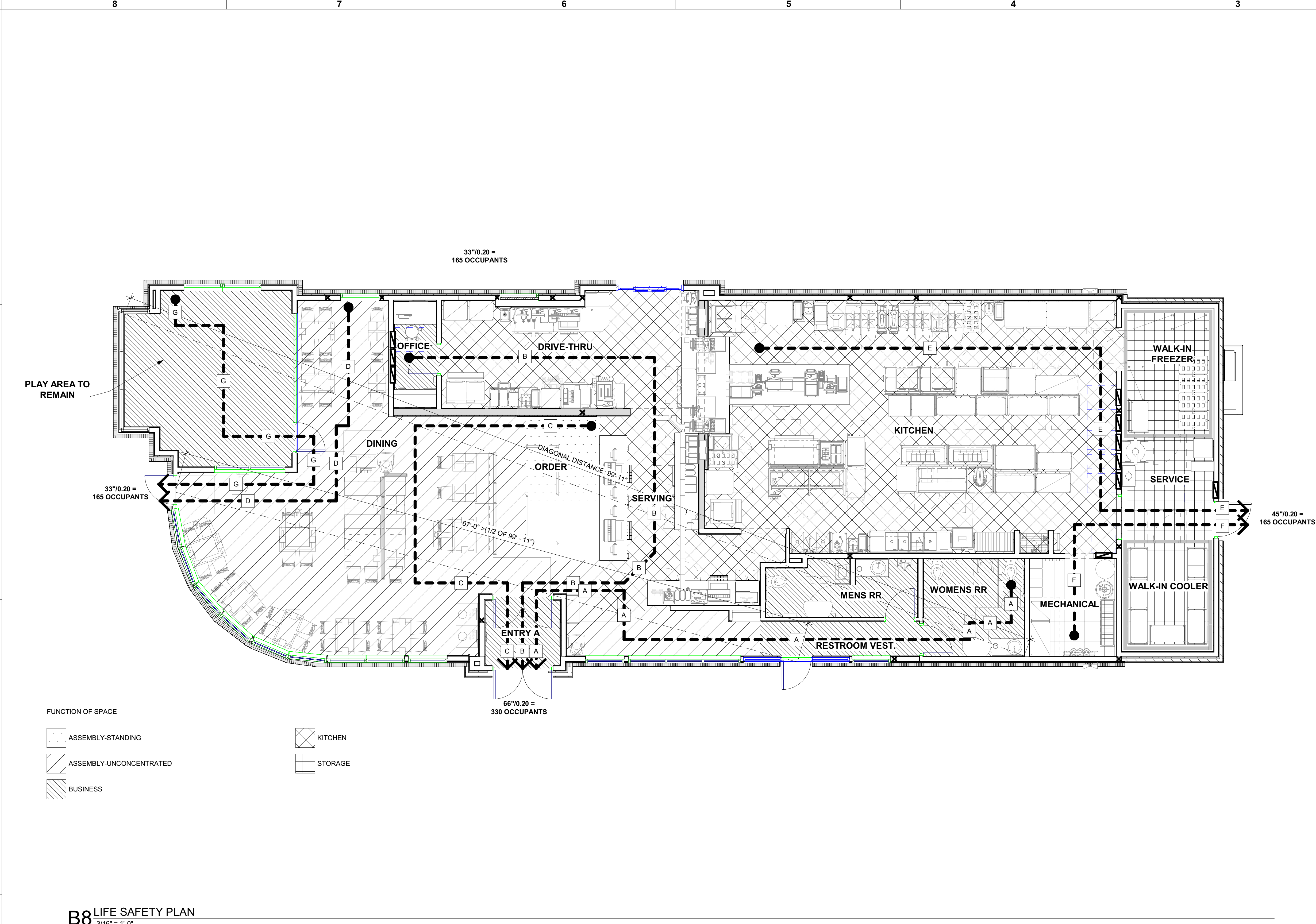

FUNCTION OF SPACE

- ASSEMBLY-STANDING
- ASSEMBLY-UNCONCENTRATED
- BUSINESS

- KITCHEN
- STORAGE

B8 LIFE SAFETY PLAN  
3/16\"/>

LIFE SAFETY PLAN LEGEND  
N.T.S.

FE-1

10# CLASS K FIRE EXTINGUISHER ON WALL BRACKET. PROVIDE WITHIN 30 FEET MAX. TRAVEL DISTANCE IN KITCHEN

FE-2

10# CLASS ABC FIRE EXTINGUISHER ON WALL BRACKET. PROVIDE WITHIN 75 FEET MAX. TRAVEL DISTANCE

EMERGENCY LIGHTING  
SEE ELECTRICAL

MAX DISTANCE OF TRAVEL (FBC): 200'-0"

- FIRE CODE NOTES
- SPRINKLER SYSTEM NOT REQUIRED BY LOCAL JURISDICTION.
  - PROVIDE HOOD SUPPRESSION SYSTEM AS SHOWN ON MECHANICAL DRAWINGS.
  - PROVIDE FIRE ALARM SYSTEM AS REQUIRED BY CODE OR JURISDICTION.
  - PROVIDE GLASS TYPES AS SHOWN ON EXTERIOR AND INTERIOR ELEVATIONS.
  - PROVIDE #10 ABC GENERAL PURPOSE FIRE EXTINGUISHERS THROUGHOUT BUILDING. QUANTITIES AND LOCATIONS PER LOCAL JURISDICTION.
  - PROVIDE CLASS K FIRE EXTINGUISHERS IN KITCHEN AREAS ARE REQUIRED BY CODE.

- BUILDING CODE NOTES
- PROVIDE FIREBLOCKING WITHIN CONCEALED SPACES PER LOCAL REQUIREMENTS.
  - PROVIDE DRAFTSTOPPING IN ATTIC AS SHOWN ON REFLECTED CEILING PLAN.
  - PROVIDE THERMAL AND SOUND INSULATION WITH FIRE CLASSIFICATIONS AS INDICATED IN SPECS.
  - PROVIDE ROOFING MATERIALS WITH FIRE CLASSIFICATIONS AS INDICATED IN SPECS.
  - PROVIDE CEILING FINISHES WITH FIRE CLASSIFICATIONS AS INDICATED IN SPECS.
  - OCCUPANT LOAD SIGN BY G.C.: PROVIDE 2"X8" BLACK SIGN WITH 1/2" WHITE HELVETICA LETTERS STATING MAXIMUM OCCUPANT LOAD AS INDICATED IN ARCH DRAWINGS.
  - CHICK-FIL-A IS REQUIRING SPECIAL INSPECTIONS IN ACCORDANCE WITH CHAPTER 17 OF THE INTERNATIONAL BUILDING CODE.

PLUMBING FIXTURE COUNTS

TOTAL BUILDING OCCUPANT LOAD:	104
LOAD DISTRIBUTION:	50% MALE AND 50% FEMALE
DISTRIBUTION COUNT:	52 MALE AND 52 FEMALE
LAVATORIES PROVIDED REQUIRED (PER CHAPTER 4 IPC AND CHAPTER 29 IBC):	
MALE LAVATORIES:	52 / 200 = 1
FEMALE LAVATORIES:	52 / 200 = 1
LAVATORIES PROVIDED:	
MALE LAVATORIES:	1
FEMALE LAVATORIES:	1
WATER CLOSETS REQUIRED (PER CHAPTER 4 IBC AND CHAPTER 29 IBC):	
MALE WATER CLOSETS:	52 / 75 = 1
FEMALE WATER CLOSETS:	52 / 75 = 1
WATER CLOSETS PROVIDED:	
MALE WATER CLOSETS:	1 WATER CLOSETS
FEMALE WATER CLOSETS:	1 URINALS 2 WATER CLOSETS

EGRESS

1. REQUIRED WIDTH OF EGRESS 31.8"

2. WIDTH OF EGRESS PROVIDED

EXIT #1 = 69"  
EXIT #2 = 33"  
EXIT #3 = 33" (STAFF ONLY)  
EXIT #4 = 45" (STAFF ONLY)  
TOTAL: 180" TOTAL

EGRESS PATH

EGRESS PATH	EGRESS DISTANCE
A	68'-3"
B	69'-8"
C	53'-1"
D	39'-8"
E	67'-7"
F	29'-6"
G	49'-8"

MAX DISTANCE OF TRAVEL (FBC): 200'-0"